

Ø 19 mm

TOPTEK®  
HARDWARE ELECTRONIC MANUFACTURER



## P-TOP-19B



Diameter: Ø 19mm  
Switch Rating: 5A/250VAC  
Contact Configuration: 1NO  
Operation Type:

- Momentary

The Front Shape: Ball  
The Crust Material:

- Stainless steel
- Copper plating

IP Degree: IP67, IK10

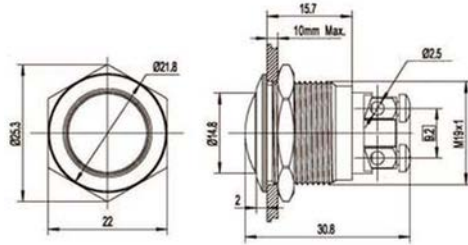

14  
\*  
49

## P-TOP-19B-4



Diameter: Ø 19mm  
Switch Rating: 5A/250VAC  
Contact Configuration: 1NO  
Operation Type:

- Momentary

The Front Shape: High  
The Crust Material:

- Stainless steel
- Copper plating

IP Degree: IP67, IK10

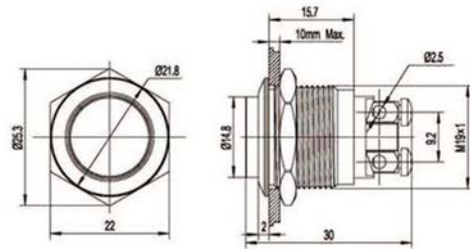

## P-TOP-19B-2-J



Diameter: Ø 19mm  
Switch Rating: 5A/250VAC  
Contact Configuration: 1NO  
Operation Type:

- Momentary

The Front Shape: Flat  
The Crust Material:

- Stainless steel
- Copper plating

IP Degree: IP67, IK10

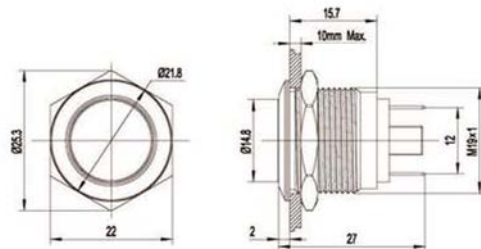

## P-TOP-19B-J



Diameter: Ø 19mm  
Switch Rating: 5A/250VAC  
Contact Configuration: 1NO  
Operation Type:

- Momentary

The Front Shape: Ball  
The Crust Material:

- Stainless steel
- Copper plating

IP Degree: IP67, IK10

